

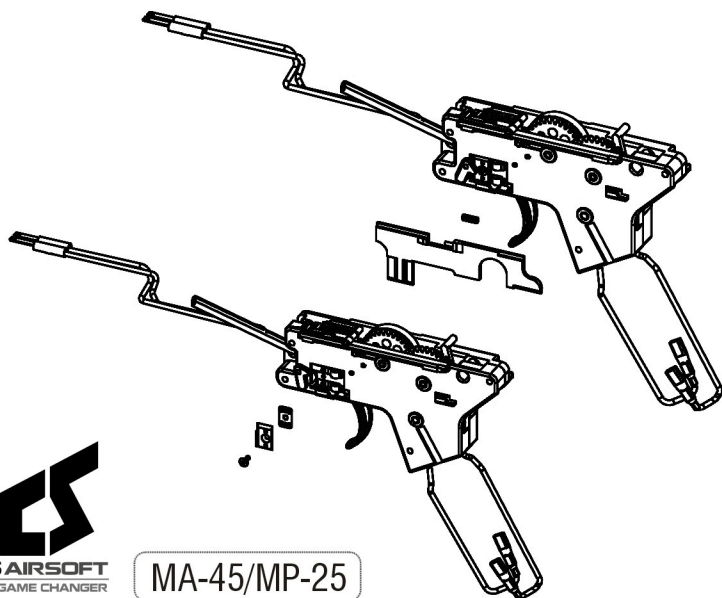

MA-45/MP-25



先取下射選連動片及連動片彈簧

1. 將檔片向左撥動至底
2. 使用十字起子將電閘組螺絲鬆開
3. 取下電閘導片護蓋
4. 將電閘導電片放入電閘導電片
(需將導電片凸點朝向電閘銅片)
5. 再依序將導片護蓋及螺絲鎖入
6. 再將射選連動片及連動片彈簧裝即可

Remove the CES switch plate plate and spring.

1. Turn the anti-reversal latch all the way to the left.
2. Unscrew the bolt with philips type screwdriver.
3. Remove the switch set plate.
4. Insert the electric chip into electric socket.
(Make sure the connector is fitting correctly)
5. Install the switch set plate and screw.
6. Install the spring and CES switch plate back.



MA-45/MP-25

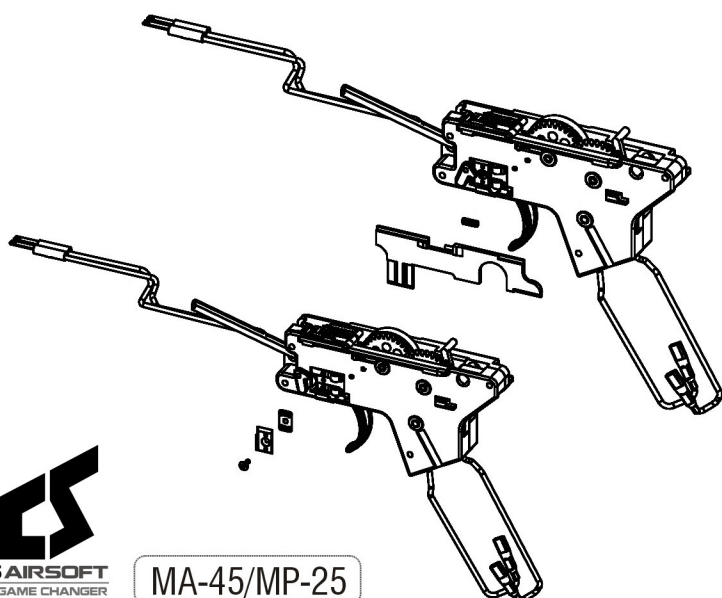

先取下射選連動片及連動片彈簧

1. 將檔片向左撥動至底
2. 使用十字起子將電閘組螺絲鬆開
3. 取下電閘導片護蓋
4. 將電閘導電片放入電閘導電片
(需將導電片凸點朝向電閘銅片)
5. 再依序將導片護蓋及螺絲鎖入
6. 再將射選連動片及連動片彈簧裝即可

Remove the CES switch plate plate and spring.

1. Turn the anti-reversal latch all the way to the left.
2. Unscrew the bolt with philips type screwdriver.
3. Remove the switch set plate.
4. Insert the electric chip into electric socket.
(Make sure the connector is fitting correctly)
5. Install the switch set plate and screw.
6. Install the spring and CES switch plate back.



MA-45/MP-25

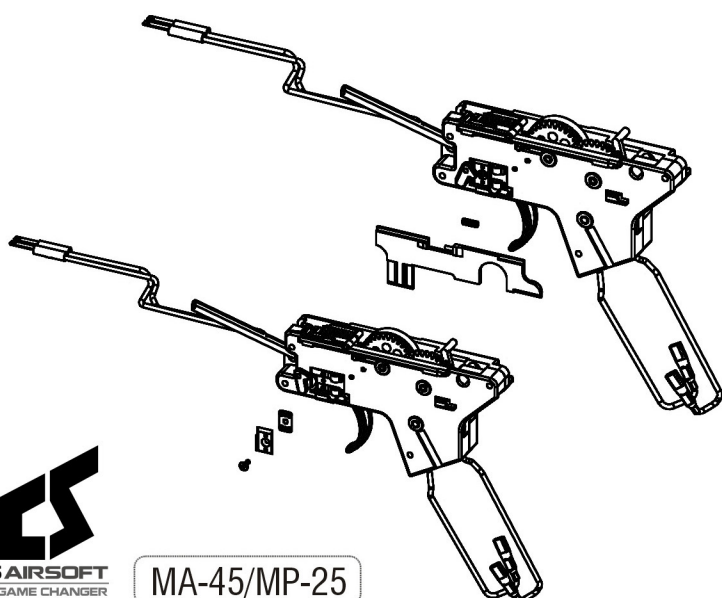

先取下射選連動片及連動片彈簧

1. 將檔片向左撥動至底
2. 使用十字起子將電閘組螺絲鬆開
3. 取下電閘導片護蓋
4. 將電閘導電片放入電閘導電片
(需將導電片凸點朝向電閘銅片)
5. 再依序將導片護蓋及螺絲鎖入
6. 再將射選連動片及連動片彈簧裝即可

Remove the CES switch plate plate and spring.

1. Turn the anti-reversal latch all the way to the left.
2. Unscrew the bolt with philips type screwdriver.
3. Remove the switch set plate.
4. Insert the electric chip into electric socket.
(Make sure the connector is fitting correctly)
5. Install the switch set plate and screw.
6. Install the spring and CES switch plate back.